

# DELTA®

DELTA® protects property. Saves energy. Creates comfort.

DÖRKEN



## DELTA®-PT

### Converts damp cellars into habitable rooms.

Ventilated dimpled membrane incorporating a bonded mesh.  
Guaranteed against degradation for 25 years.



STANDARD QUALITY

■ Refurbishment system

■ For render and plaster coats

■ For interior application

**Want a refurbishing robust foundation for plaster and render coats? DELTA®-PT for refurbishing and insulating damp cellar walls!**

**Improve your cellar:**

# DELTA®-PT



■ **DELTA®-PT**

Damp walls are often impossible to dry out. In these cases, applying a waterproof dimpled sheet system will transform damp cellars into habitable rooms. DELTA®-PT isolates defective and damp and salt affected walls from the inside. The system forms a reliable and durable support for new plaster and/or render coats, ensuring long term protection from penetration damp in cellars.

■ **DELTA®-Accessories**

DELTA®-PT-PROFIL, an edge sealing strip with integrated ventilation slits, DELTA®-MS KNOFF, and DELTA®-MS DÜBEL are ideal for installing DELTA®-PT. DELTA®-PT Fixing plugs designed specifically for Supporting DELTA®-PT and subsequent fixings. DELTA® Rope sealer designed to seal DELTA®-PT Fixing plugs. DELTA® Mastic designed for overlap joints and internal and external corner profiles.

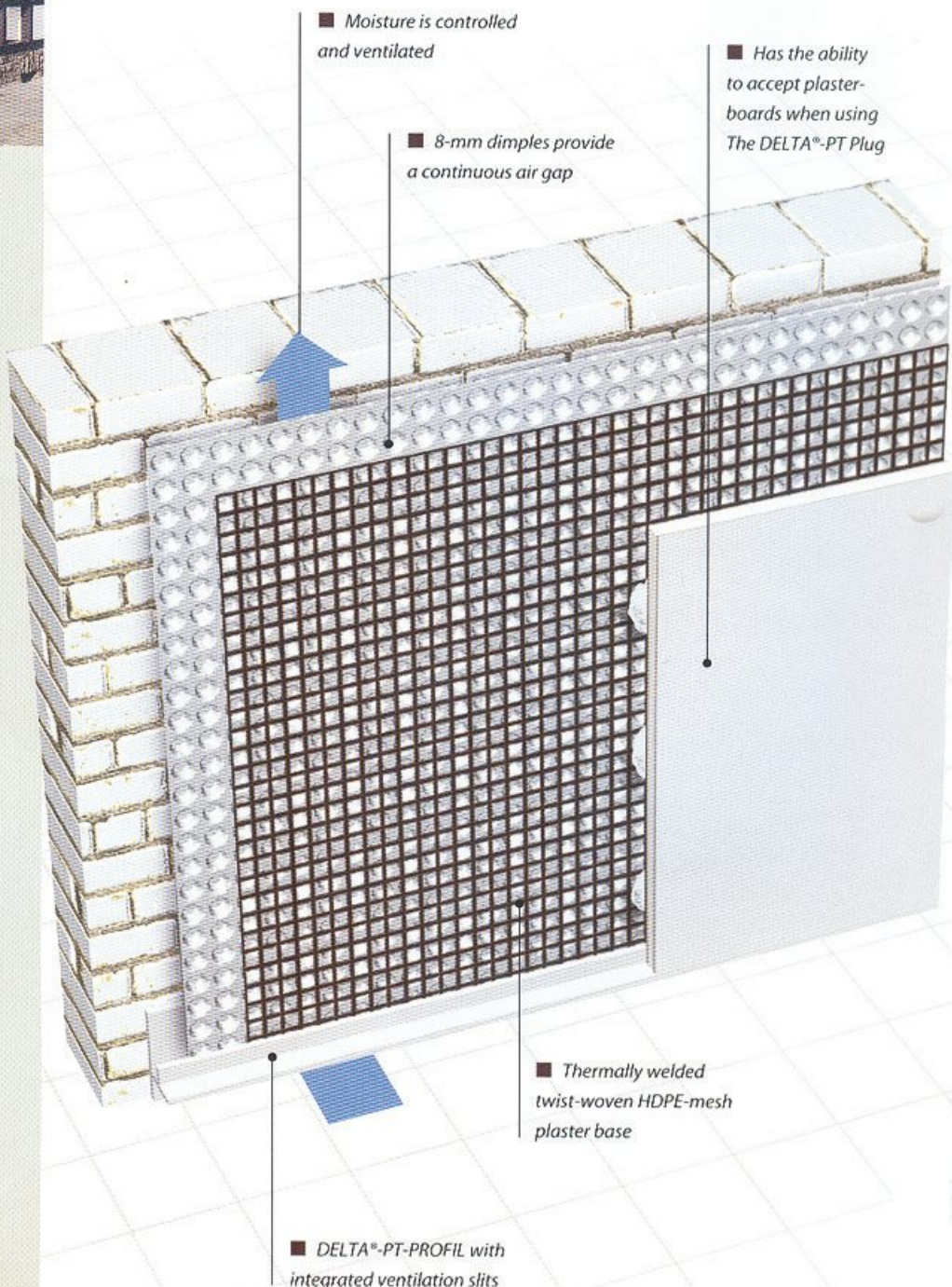

STANDARD QUALITY

DELTA® quality branded products made by Dörken.

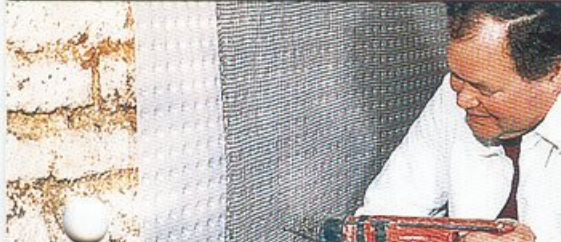

Installation is easy.



Simply lay on plaster with a trowel.



In tunnels, DELTA®-PT supports shotcrete applications.

#### DELTA®-PT ...

- ... consists of an highly impact-resistant, flexible, waterproof dimpled sheet made of special high-density polyethylene incorporated with a bonded twist-woven HDPE-mesh to provide efficient plaster or render support.
- ... is extremely reliable, with mesh welded to the dimpled sheet to prevent delaminating.
- ... forms a waterproof, robust providing reliable support for plasters and render coats or, plasterboard panels.
- ...has an excellent temperature range from - 30 degrees to + 80 degrees C.
- ... is not affected by acids, alkaline solutions, oil, or solvents, as well as being acceptable for use in drinking water applications.
- ... creates a ventilation air gap between damp cellar walls and new plaster coats with its 8-mm dimples.
- ... is applied vertically with lateral overlaps. The system is transparent making fixing easy as good fixing points can be easily identified.
- ... is also used for water-proofing tunnels and subterranean transportation systems such as London Underground stations.
- ... is guaranteed against degradation for 25 years.



DELTA®-PT forms a waterproof, reliable support for plaster and render coats or plasterboard panels.

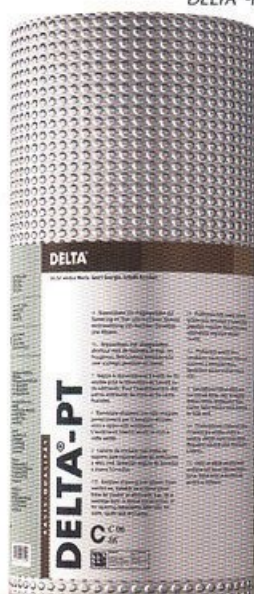

### Important Handling Information.

#### For normal plaster coats ...

... DELTA®-PT is a system for refurbishing damp walls. It should not be installed where hydrostatic pressure exists unless used as a drained cavity with floor system perimeter drainage and a collection/evacuation system.

#### For render coats ...

... DELTA®-PT safely insulates cellar walls. Make sure that any coats applied are low-tension. Where relatively large areas need to be coated, fibres should be added in the outer render to avoid shrinkage cracking.

#### For plasterboard panels ...

... DELTA®-PT forms an ideal support for drying damp masonry whilst providing permanently, dry and contamination free finishes. Unusable rooms become inhabitable space increasing property value.

Where the surface of a damp wall is extensively covered with hygroscopic salt, it is advisable to use the system as a barrier without the ventilation option. The membrane can be sealed at the wall floor junction or joined to an existing floor damp proof membrane.

# DELTA®-PT

## Technical Data Overview:

Material	HDPE with a twisted HDPE mesh.
Suitable for	Vertical application to cellar and tunnel walls to be covered with render and plaster coats or plasterboard panels.
Compression resistance	approx. 70 kN/m <sup>2</sup>
Tensile strength	approx. 400 N/3 cm
Air gap between dimples	approx. 5.5 l/m <sup>2</sup>
Square weight	approx. 530 g/m <sup>2</sup>
Dimple height	approx. 8 mm
Sheet overlap	approx. 20 cm
Roll size	20 m x 2 m
Material consumption	DELTA®-PT – approx. 1.15 m <sup>2</sup> , approx. 1 m of DELTA®-PT-PROFIL and approx. 15 DELTA®-MS DÜBEL per square metre of wall

# DELTA®-Accessories for DELTA®-PT.

**Dörken makes your life easier – systematically.**

You are sure to appreciate these handy DELTA®-Accessories:



### DELTA®-PT-PROFIL

Ventilation moulding cap, for ceiling and floor installation.



### DELTA®-MS KNOPF

Washer which keeps the material from tearing during attachment.



### DELTA®-MS DÜBEL

Plastic wall plug for sheet attachment.

# DELTA®

*DELTA® System ...*

*... for owners:*

*"... What I get is a mature problem solution provided at a fair price by the top specialist in quality branded products!"*

*... for workers:*

*"... What I get is a complete system made by a single manufacturer that enables me to do anything to the owner's entire satisfaction. There is no safer way!"*

*... for planners:*

*"... I can be certain that both innovative and standard products will be used in implementing my roof and cellar plans in a systematic and forward-looking way."*



Dörken GmbH & Co. KG  
Wetterstraße 58  
D-58313 Herdecke  
Tel.: +49 23 30/63-0  
Fax: +49 23 30/63-355  
bvf@doerken.de  
www.doerken.de

Ein Unternehmen der Dörken-Gruppe

■ Standard requests for tender and detailed installation instructions for all DELTA® products may be obtained from [www.doerken.de](http://www.doerken.de) as PDF files for you to print out and save.

DELTA® is a registered trademark of Ewald Dörken AG, Herdecke, Germany.

550283 7.10/W1

## DELTA®-PT

### Installation Instructions

- 1. Install DELTA®-PT vertically. Use plugs to fix DELTA®-PT-PROFIL strips to the upper and lower sheet edges. For easier cleaning, DELTA®-PT-PROFIL may be attached above any skirting that may be present.
- 2. Fixing plugs should be spaced approx. 25 cm apart both horizontally and vertically. Start in the centre of each sheet and work towards the sides. If you drill into a void in the wall, use a DELTA® Rope sealing compound to seal the hole so as to avoid bridging.
- 3. Sheets should overlap by approx. 20 cm along the mesh-free edge. These sheet sections should be fixed with DELTA®-PT Plug after the edges have been fitted together, sealed and inserted into the DELTA®-PT-PROFIL strip.
- 4. There should be no bridges between the plaster and the damp cellar wall. Reinforce and seal butt joints in corners. Apply DELTA® Mastic compound to protect protrusions for pipes, electric sockets, doors, etc.
- 5. Plaster should be trowel applied in two coats. Do not apply the second coat before the first has initially set. Suitable coats include plaster (not in rooms where water is splashed about and relative humidity exceeds 90 % continuously) and render (use only low-tension material and added fibres into the outer layer when covering relatively large areas so as to avoid shrinkage cracking).
- 6. Do not use DELTA®-PT-PROFIL with plasterboard panels. To enable the moisture-laden air to circulate, leave a gap 1 cm wide below the ceiling and above the floor.

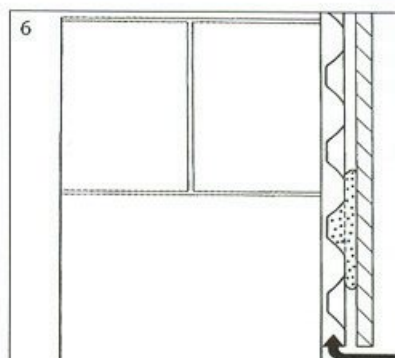
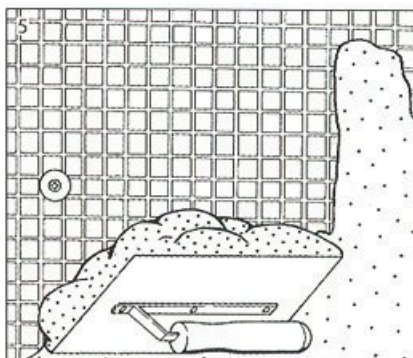
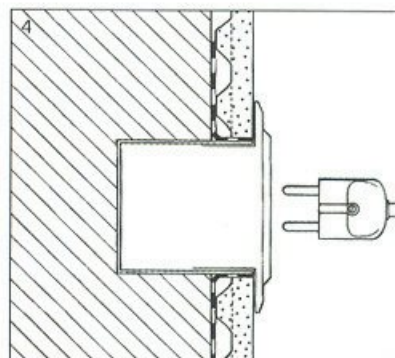
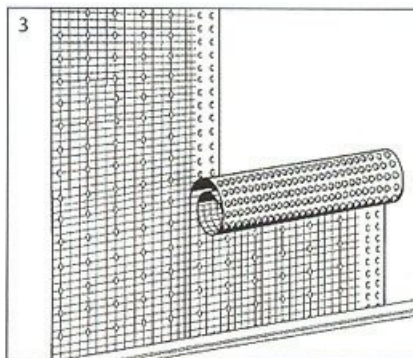
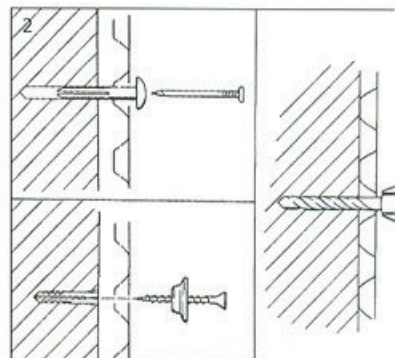
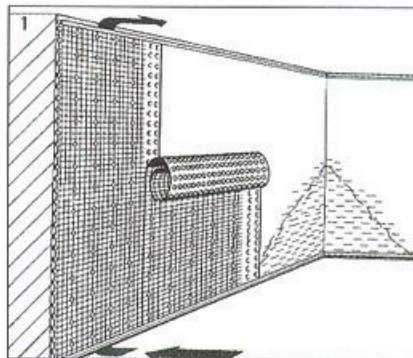

You will find detailed installation instructions for DELTA®-PT on the internet at [www.doerken.de](http://www.doerken.de) in the form of a PDF file for you to print out and save.

**Fax: +49 23 30/63-355**Dörken GmbH & Co. KG  
Wetterstraße 58  
D-58313 Herdecke**Request for tender DELTA®-PT**

Item No.	Qty.	Specifications	Price/Unit	Price Total
1	..... l.m.	<b>DELTA®-PT-PROFIL</b> (manufacturer: Dörken GmbH & Co. KG, D-58311 Herdecke) to be attached to the top and bottom wall edges with plastic fixing plugs spaced approx. 75 cm apart.		
2	..... m²	Check wall surface, remove any loose plaster, and fill up any major voids with mortar. Cover with DELTA®-PT (manufacturer: Dörken GmbH & Co. KG, D-58311 Herdecke) and attach sheets with plastic fixing Plugs arranged horizontally and vertically in conformance with the manufacturer's instructions. Dry lining should be installed so that a gap no less than 1 cm wide is left along the ceiling and the floor. For plaster-covered walls use DELTA®-PT-PROFIL.		
3	..... each/l.m.	Protect openings for pipes, windows, doors, electric sockets, etc. from bridging either by applying DELTA® Mastic sealing compound.		
4	..... m²	Cover the wall with plaster/render in accordance with the manufacturers recommendations, to a minimum two coat thickness of approx. 15 mm (up to the DELTA®-PT-PROFIL edge).		
5	..... m²	To attach plasterboard panels, apply dabs of adhesive spaced 25 cm apart on the head of each DELTA®-PT fixing plug.		