

CEMENTITIOUS - POLYMERS FLEXIBLE WATERPROOFING MEMBRANE, TWO COMPONENTS

DESCRIPTION

SMARTFLEX is a liquid - applied waterproofing membrane. It is a unique blend of special cement polymer and fine quartz. **SMARTFLEX** is supplied in two component sets. When mixed, the two components form an easy to apply slurry. The **SMARTFLEX** slurry dries to form a flexible waterproofing membrane. This membrane can bridge cracks and is firmly bonded to the substrate. **SMARTFLEX** is non-toxic and is specially suited for damp surfaces. **MARTFLEX** a superior formulation with high polymer content. This product has good elongation & bond strength capabilities and is suitable for a wide range of water-retaining / water-excluding structures. Typically used for: Swimming pools, Basement, Water tank, Lift pit, Terrace, Roofs, Bathroom, Water tanks, Green roof - Planter box (grass, shrubs, not a big tree: bamboo, coconut,...)



PACKAGING & COVERAGE

The **SMARTFLEX** packed 20,00 kg / set of two component: (Component A- 6,00kg) and (Component B-14,00kg). Normal consumption: @ 1.5kg / m² / 2 coats, thickness 0.8 - 1.0mm. Depending on the surface conditions, Items to be waterproofed, the consumption can be changed.

TECHNICAL DATA (Depend on the testing method & surface condition)	RESULT
Substrate adhesion	0.8 -1.5 N/mm ²
Crack-bridging width without reinforcement	Up to: 1.0mm
Crack-bridging width polyester / polyglass fiber reinforcement	Up to: 3.0mm
Tensile Strength	2.0 - 2.5 Mpa
Flexural strength	≥ 10 N/mm ² (28 days)
Elongation at Break	130 - 200%
Compressive strength	40 N/mm ²
Water pressure resistance	Positive: 7 bar / Negative: 3 bar
Pot Life	15 - 180 min after mixing

APPLICATION TOOLS

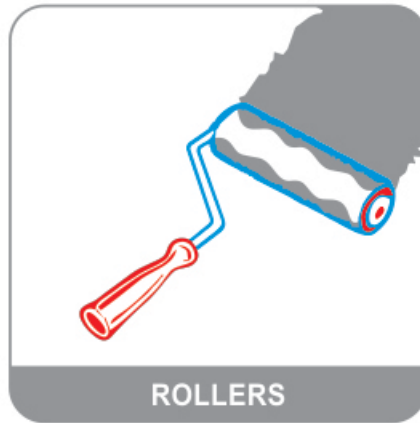

FEATURES

- **DAMP SURFACES:**
SMARTFLEX is a cement-based product & is specially suited for application on wet or damp surfaces.
- **CRACK-BRIDGING:**
Up to: 1.0mm width without reinforcement. Up to: 3.0mm width polyester / polyglass fiber reinforcement.
- **NON-TOXIC:**
SMARTFLEX is a water-based product which is odorless & non-toxic. It is most suitable for application in confined areas.
- **WATER POTABILITY:**
SMARTFLEX has been tested & certified suitable for use in contact with potable water.
- **GOOD BONDING:**
SMARTFLEX has high substrate adhesion
- **FLEXIBLE:**
SMARTFLEX is flexible & easy to apply in corners and uneven surfaces.

WATERPROOFING BUILD UP SOLUTION

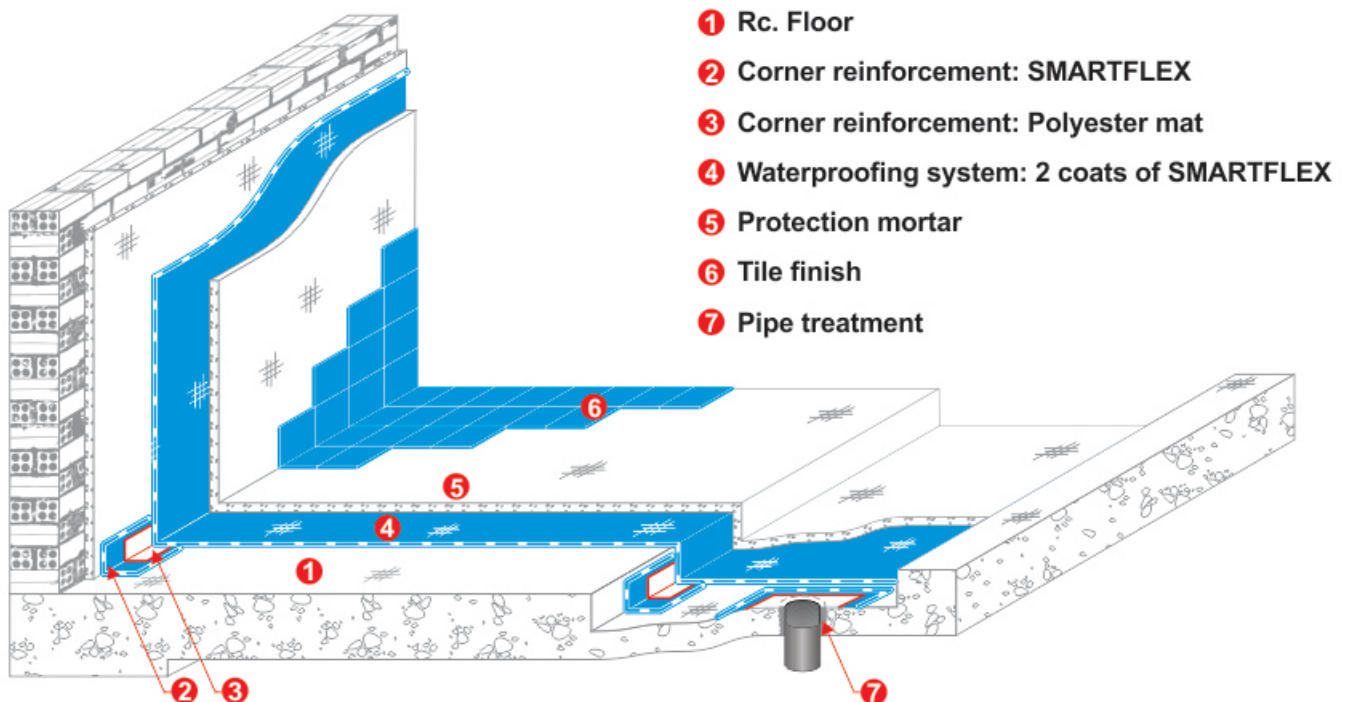

USES



MIXING INSTRUCTIONS



Pour Part A (Polymer Liquid) into an empty & clean container.



Pour Part B (Powder) into container that has Part A (Polymer) within. Ratio 1part of Polymer (A) to 2.3 Parts of Powder (B)



Use electrical mixer or square stick. Mixing for at least 5-10 minutes. Then mix 2nd time prior to application.

REMARKS:

Mixing ratio 1: 2.33, 1Kg of part A(polymer component) is mixed with 2.33Kg of part B(powder component) it can be diluted 5~10% of clean water by volume for easier application.

WATERPROOFING APPLICATIONS INSTRUCTIONS

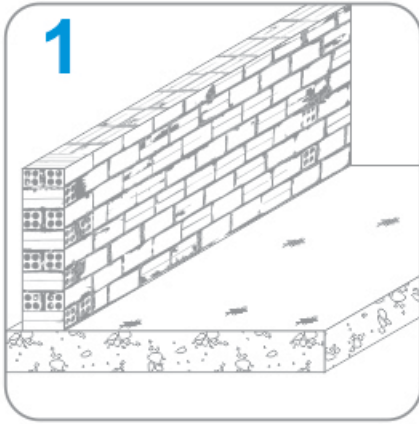

The surface to be waterproofed should be smooth, clean & sloped 1.5 - 2%.

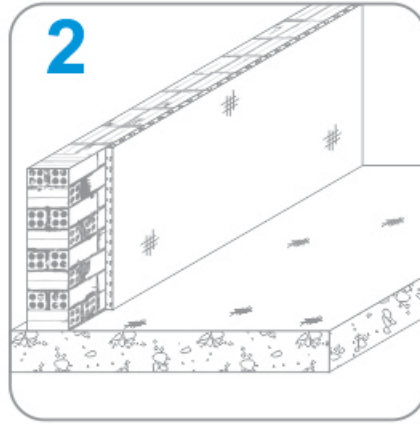

Cement-Sand fillet to be done the at corner, pipe treatment & plastering the upturn & wall.

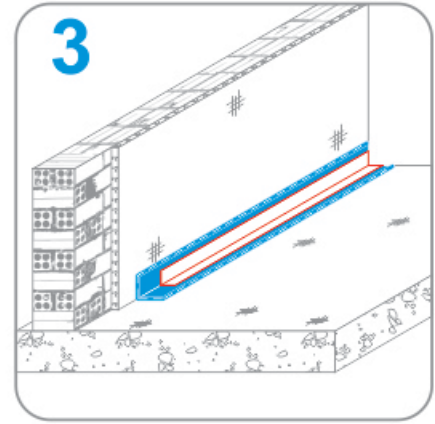

Apply **SMARTFLEX** & Polyester mat reinforcement at the corners, cracks & pipe's collars,...

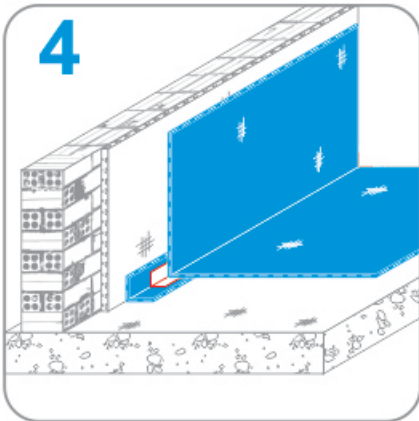

Apply 2 coats of **SMARTFLEX** on to all floors & walls.

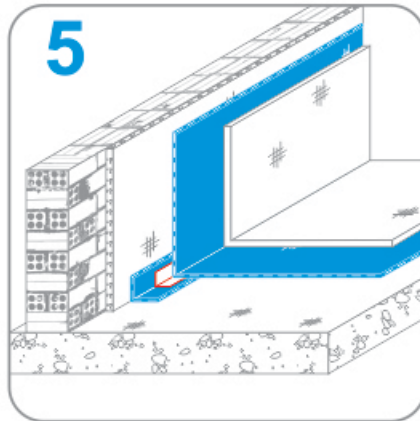

Protected mortar to cover the **SMARTFLEX** waterproofing membrane within 48hrs.

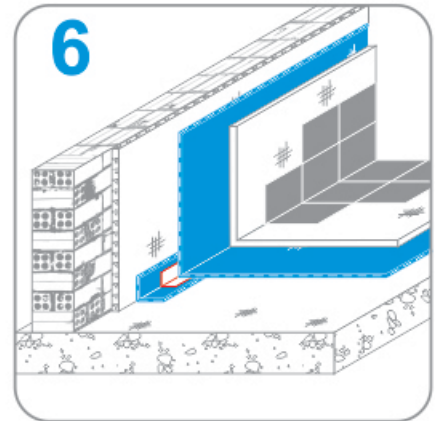

Tile finishing (Options).

REMARKS:

Saturate the substrate to be waterproofed prior to application of **SMARTFLEX**. Normal consumption: @ 1.5kg / m² / 2 coats, thickness 0.8 - 1.0 mm. Depending on the surface conditions, items to be waterproofed, the consumption can be changed. For more detail, please contact your local distributors or manufacturer.

DISCLAIMER

The information, and, in particular, the recommendations relating to the application and end-use of KOMIX products, are given in good faith based on KOMIX's current knowledge and experience of the products when properly stored, handled and applied under normal conditions in accordance with KOMIX's recommendations. In practice, the differences in materials, substrates and actual site conditions are such that no warranty in respect of merchantability or of fitness for a particular purpose, nor any liability arising out of any legal relationship whatsoever, can be inferred either from this information, or from any written recommendations, or from any other advice offered. The user of the product must test the product's suitability for the intended application and purpose. KOMIX reserves the right to change the properties of its products. The proprietary rights of third parties must be observed. All orders are accepted subject to our current terms of sale and delivery. Users must always refer to the most recent issue of the local Product Data Sheet for the product concerned, copies of which will be supplied on request.