

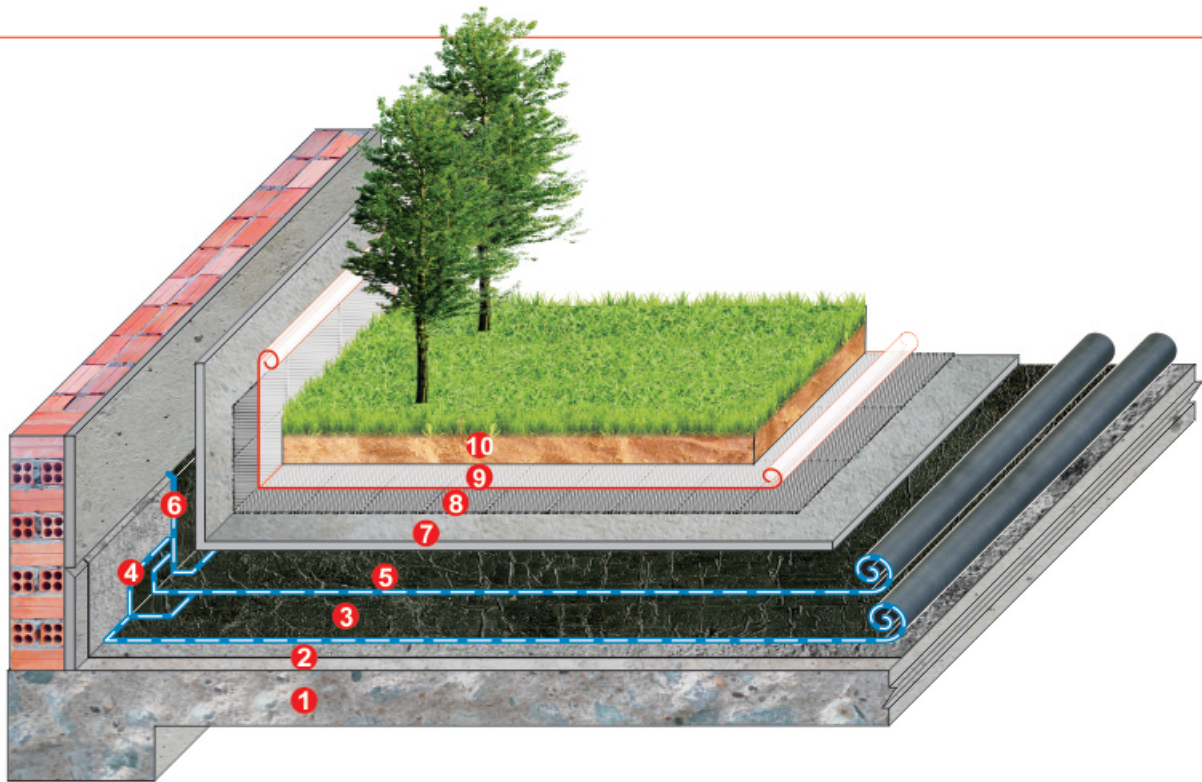

Product:  
**SOPRALENE FLAM 180**







#### WATERPROOFING TO FLOOR & WALL

1. R.C. floor slab
2. Primer coat
3. **SOPRALENE FLAM 180** 1st layer
4. **SOPRALENE FLAM 180** corner reinforcement
5. **SOPRALENE FLAM 180** 2nd layer
6. **SOPRALENE FLAM 180** to upturn
7. Protection screed
8. Drain board **VersiCell**
9. Geotextile
10. Sand thickness 30mm, soil & grass / trees.

#### CHỐNG THÂM CHO SÀN & TƯỜNG

1. Đáy B.T.C.T.
2. Lớp Primer
3. Lớp thứ 1: **SOPRALENE FLAM 180**
4. Lớp gia cố góc: **SOPRALENE FLAM 180**
5. Lớp thứ 2: **SOPRALENE FLAM 180**
6. C.thấm chân tường: **SOPRALENE FLAM 180**
7. Vữa bảo vệ
8. Tấm dẫn nước **VersiCell**
9. Vải địa kỹ thuật
10. Lớp cát dày 30mm, đất & cây trồng



## TYPICAL SPECIFICATION - QUY TRÌNH KỸ THUẬT

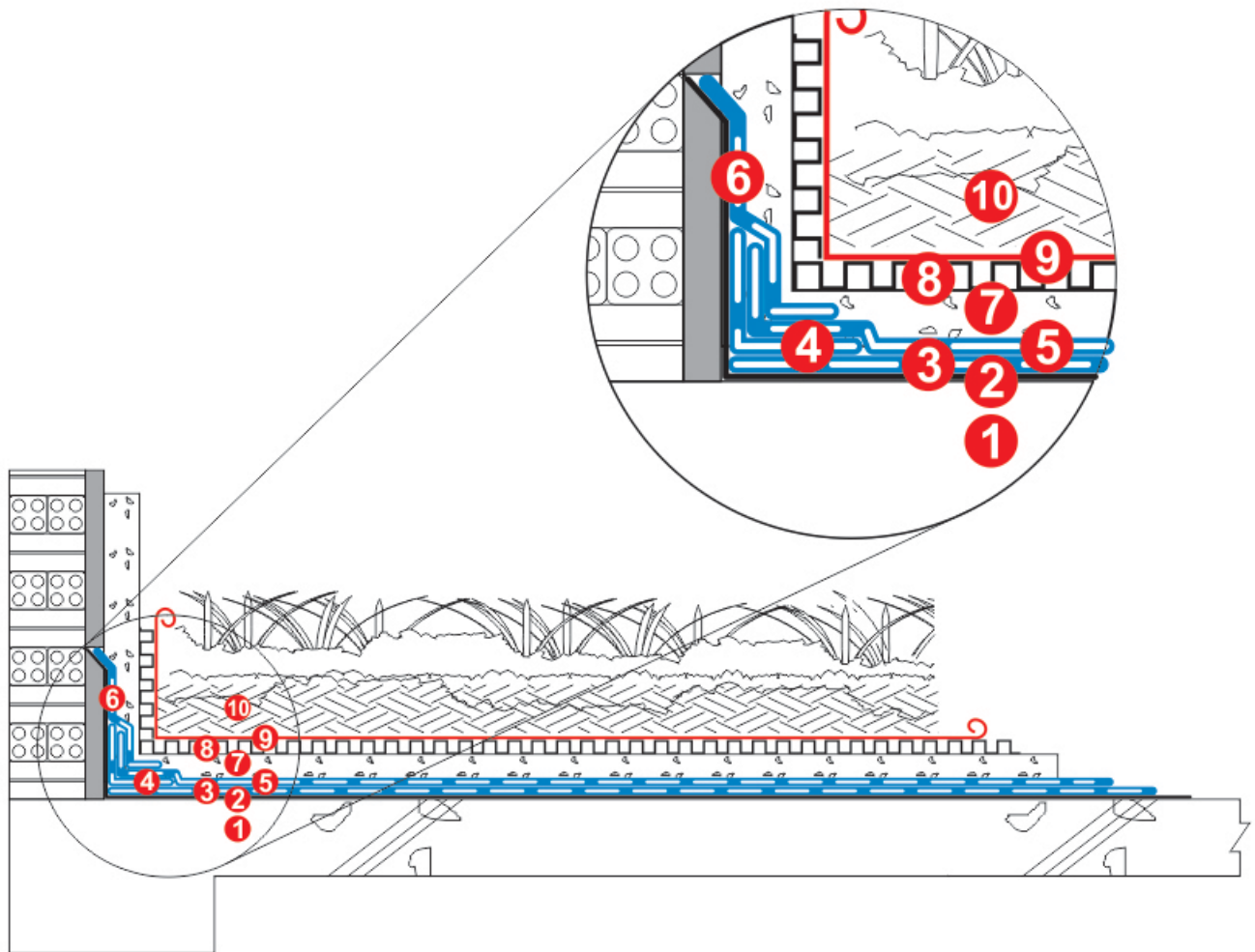

### WATERPROOFING OF / CHỐNG THẤM CHO ACCESSIBLE ROOF SÂN THƯỢNG, MÁI ĐI LẠI

Project:

#### WATERPROOFING TO FLOOR & WALL

1. R.C. floor slab / screed slop 1.5 - 2.0%
2. Primer coat
3. **SOPRALENE FLAM 180** 1st layer
4. **SOPRALENE FLAM 180** corner reinforcement
5. **SOPRALENE FLAM 180** 2nd layer
6. **SOPRALENE FLAM 180** to upturn
7. Protection screed
8. Drain board **VersiCell**
9. Geotextile
10. Sand thickness 30mm, soil & grass / trees.



Manufacture & Supplier by:



Design & installation by:

