

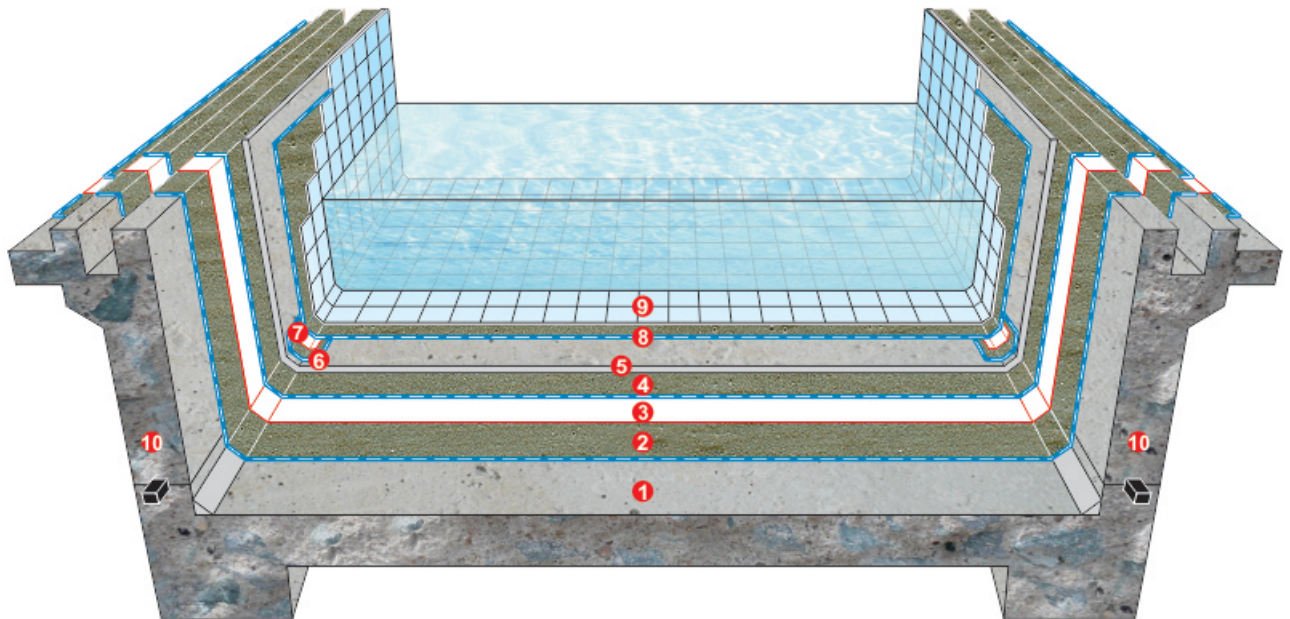

Product / sản phẩm:
SMARTFLEX





WATERPROOFING TO FLOOR & WALL

1. R.C slab.
2. Waterproofing system: 2 coats of **SMARTFLEX**
3. Poly glass reinforcement mat
4. 2 Coats of **SMARTFLEX** on the top of poly glass mat
5. Protection mortar
6. Corner reinforcement: **SMARTFLEX**
7. Polyester reinforcement mat
8. Waterproofing system: 2 coats of **SMARTFLEX**
9. tile adhesive mortar & Tile finish
10. Bentonite Hyperstop DB 2015

CHỐNG THẤM CHO SÀN & TƯỜNG

1. Sàn B.T.C.T
2. Hệ thống chống thấm: 2 lớp **SMARTFLEX**
3. Gia cố lưới thủy tinh
4. 2 lớp **SMARTFLEX** quét phủ lên lớp lưới gia cố.
5. Vữa bảo vệ
6. Gia cố góc chân tường: **SMARTFLEX**
7. Lưới gia cố Polyester
8. Hệ thống chống thấm: 2 lớp **SMARTFLEX**
9. Vữa dán gạch & gạch hoàn thiện
10. Băng cản nước Bentonite Hyperstop DB 2015



TYPICAL SPECIFICATION - QUY TRÌNH KỸ THUẬT

Product / sản phẩm:
SMARTFLEX

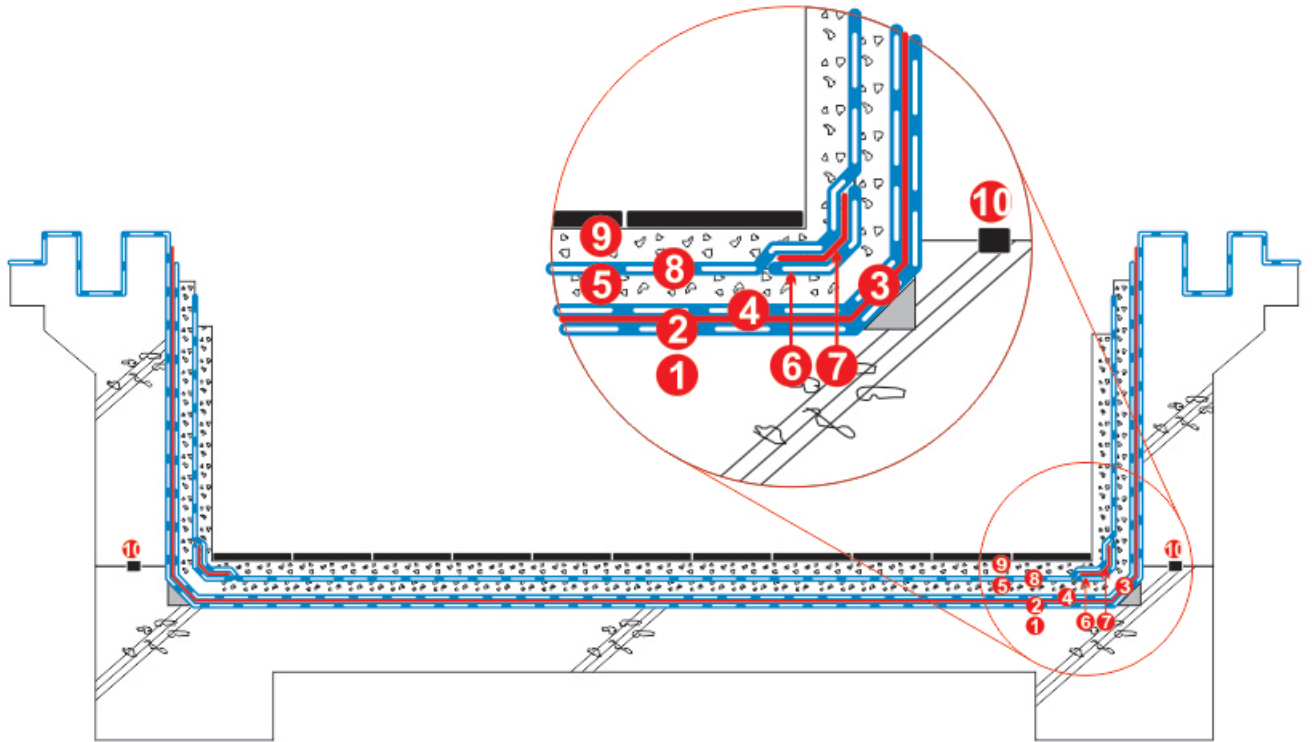

WATERPROOFING FOR / CHỐNG THẤM CHO
SWIMMING POOL
HỒ BƠI

Project:

Shop Drwg

WATERPROOFING TO FLOOR & WALL

1. R.C slab.
2. Waterproofing system: 2 coats of **SMARTFLEX**
3. Poly glass reinforcement mat
4. 2 Coats of **SMARTFLEX** on the top of poly glass mat
5. Protection mortar
6. Corner reinforcement: **SMARTFLEX**
7. Polyester reinforcement mat
8. Waterproofing system: 2 coats of **SMARTFLEX**
9. tile adhesive mortar & Tile finish
10. Bentonite Hyperstop DB 2015

Manufacture & Supplier by:



Design & installation by:

