

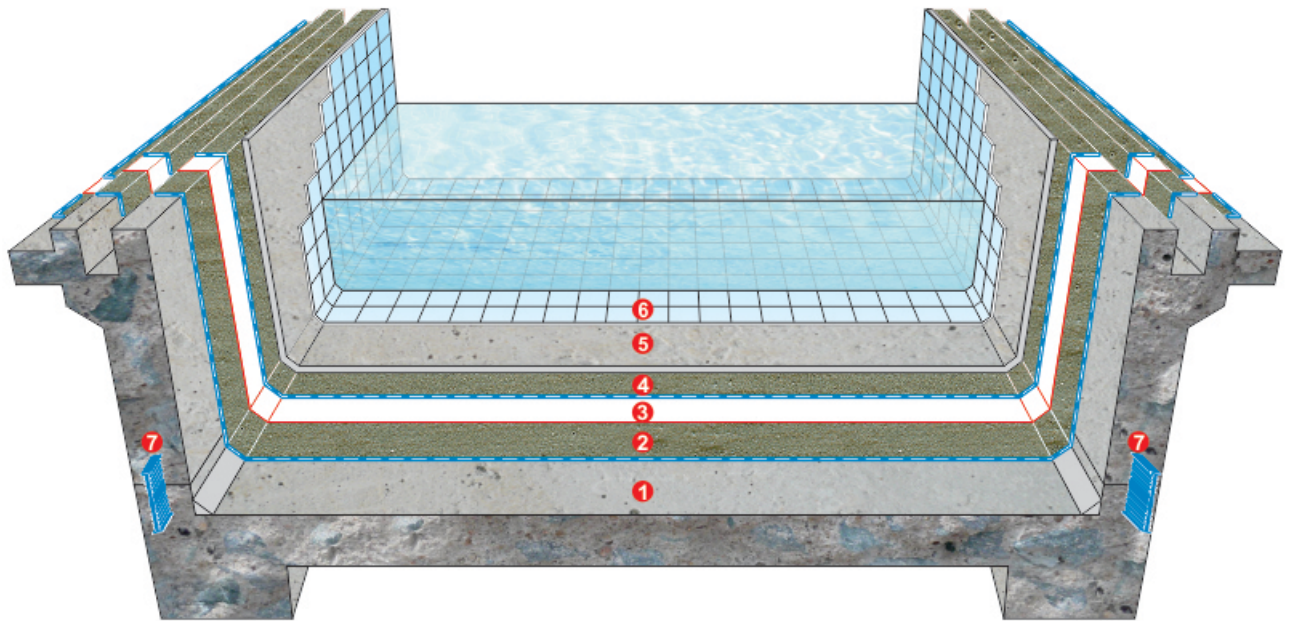

**CEMENTITIOUS POLYMER FLEXIBLE
WATERPROOFING MEMBRANE, TWO COMPONENTS
MÀNG CHỐNG THẤM LỒNG GÓC XI MĂNG - POLYMER
ĐÀN HỒI, HAI THÀNH PHẦN**





WATERPROOFING TO FLOOR & WALL

1. R.C slab, sloped down screed 1.5 ~ 2%
2. Waterproofing system: 2 coats of **SMARTFLEX**
3. Poly glass reinforcement mat
4. 2 Coats of **SMARTFLEX** on the top of poly glass mat
5. Protection / tile adhesive mortar
6. Tile finish
7. PVC waterstop

CHỐNG THẤM CHO SÀN & TƯỜNG

1. Sàn B.T.C.T, cán vữa tạo dốc 1.5 ~ 2%
2. Hệ thống chống thấm: 2 lớp **SMARTFLEX**
3. Gia cố lưới thủy tinh
4. 2 lớp **SMARTFLEX** quét phủ lên lớp lưới gia cố.
5. Vữa bảo vệ / keo dán gạch
6. Gạch hoàn thiện
7. PVC waterstop



TYPICAL SPECIFICATION - QUY TRÌNH KỸ THUẬT

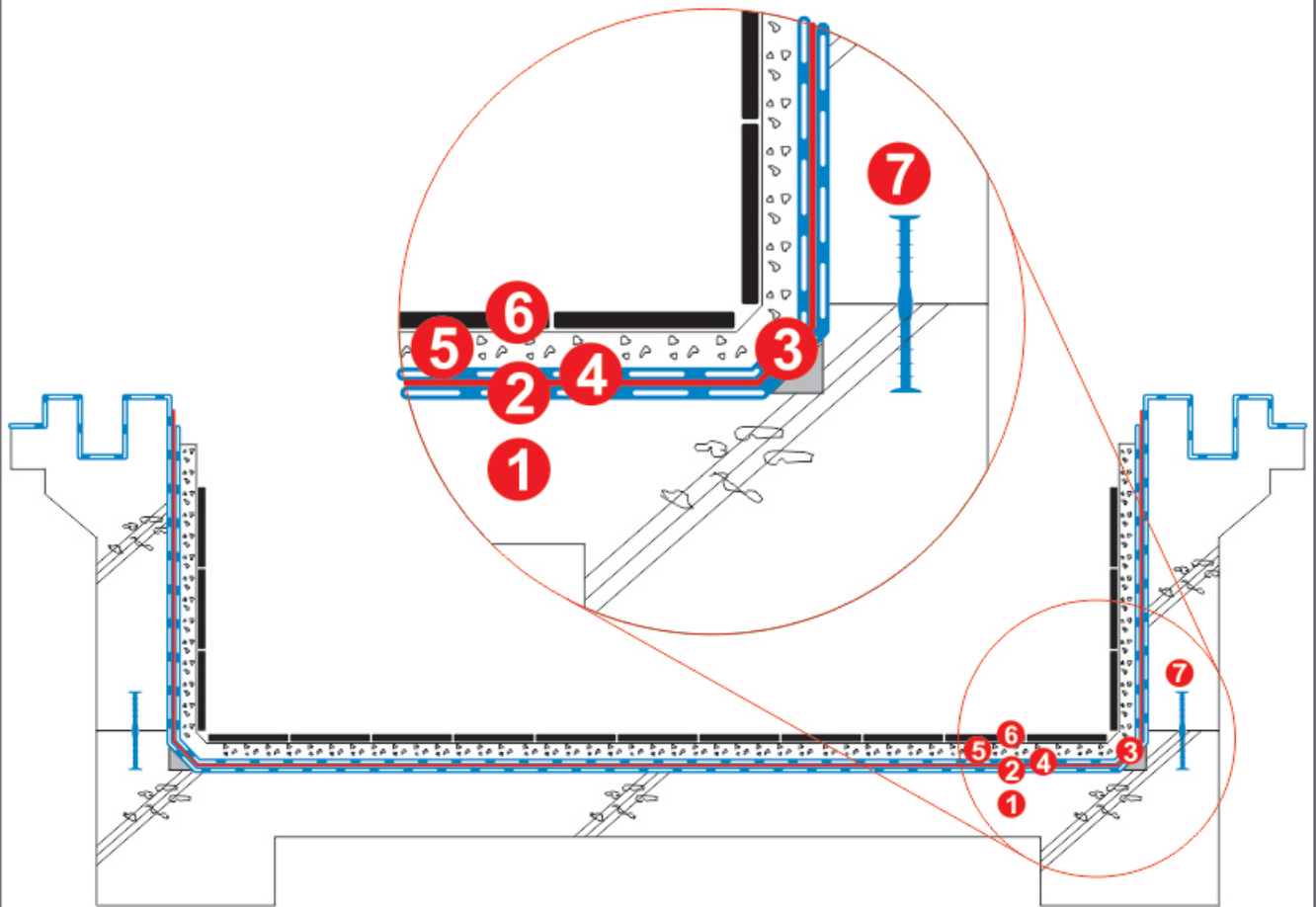

WATERPROOFING FOR / CHỐNG THẤM CHO SWIMMING POOL HỒ BƠI

Project:

Shop Drwg

WATERPROOFING TO FLOOR & WALL

1. R.C slab, sloped down screed 1.5 ~ 2%
2. Waterproofing system:
2 coats of **SMARTFLEX**
3. Poly glass reinforcement mat
4. 2 Coats of **SMARTFLEX**
on the top of poly glass mat
5. Protection / tile adhesive mortar
6. Tile finish
7. PVC waterstop



Manufacture & Supplier by:



Design & installation by:

