

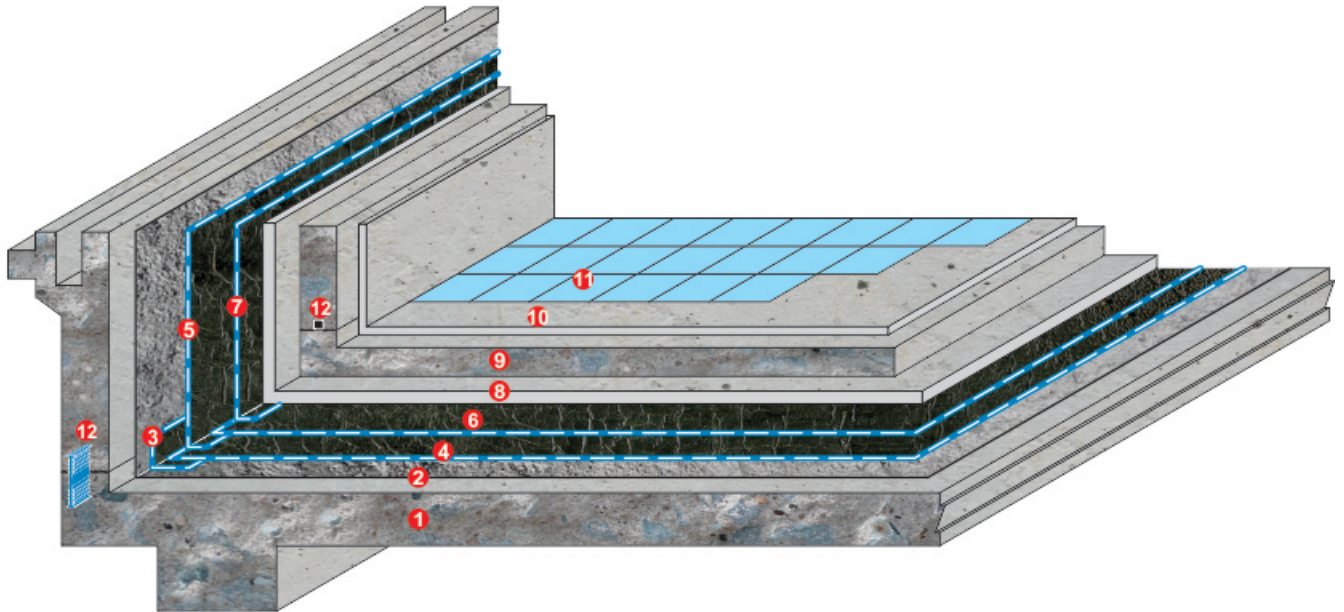

SOPRALENE FLAM 180





WATERPROOFING TO FLOOR & WALL

1. R.C slab
2. Primer coats
3. Corner reinforcement: **SOPRALENE FLAM 180**
4. Waterproofing system:
First layer **SOPRALENE FLAM 180**
5. Waterproofing upturn:
First layer **SOPRALENE FLAM 180**
6. Waterproofing system:
Second layer **SOPRALENE FLAM 180**
7. Waterproofing upturn:
Second layer **SOPRALENE FLAM 180**
8. Protection screed for floor
9. R.C protection
10. Tile adhesive mortar
11. Tile finish
12. **PVC waterstop** or **Hyperstop** (Option).

CHỐNG THẤM CHO SÀN & TƯỜNG

1. Sàn B.T.C.T
2. Lớp Primer
3. Lớp gia cố góc: **SOPRALENE FLAM 180**
4. Hệ thống chống thấm:
Lớp thứ 1: **SOPRALENE FLAM 180**
5. Chống thấm chân tường:
Lớp thứ 1: **SOPRALENE FLAM 180**
6. Hệ thống chống thấm:
Lớp thứ 2: **SOPRALENE FLAM 180**
7. Chống thấm chân tường:
Lớp thứ 2: **SOPRALENE FLAM 180**
8. Vữa bảo vệ cho sàn
9. B.T.C.T bảo vệ
10. Vữa dán gạch
11. Gạch hoàn thiện
12. (Tùy chọn) **PVC waterstop / Hyperstop**



TYPICAL SPECIFICATION - QUY TRÌNH KỸ THUẬT

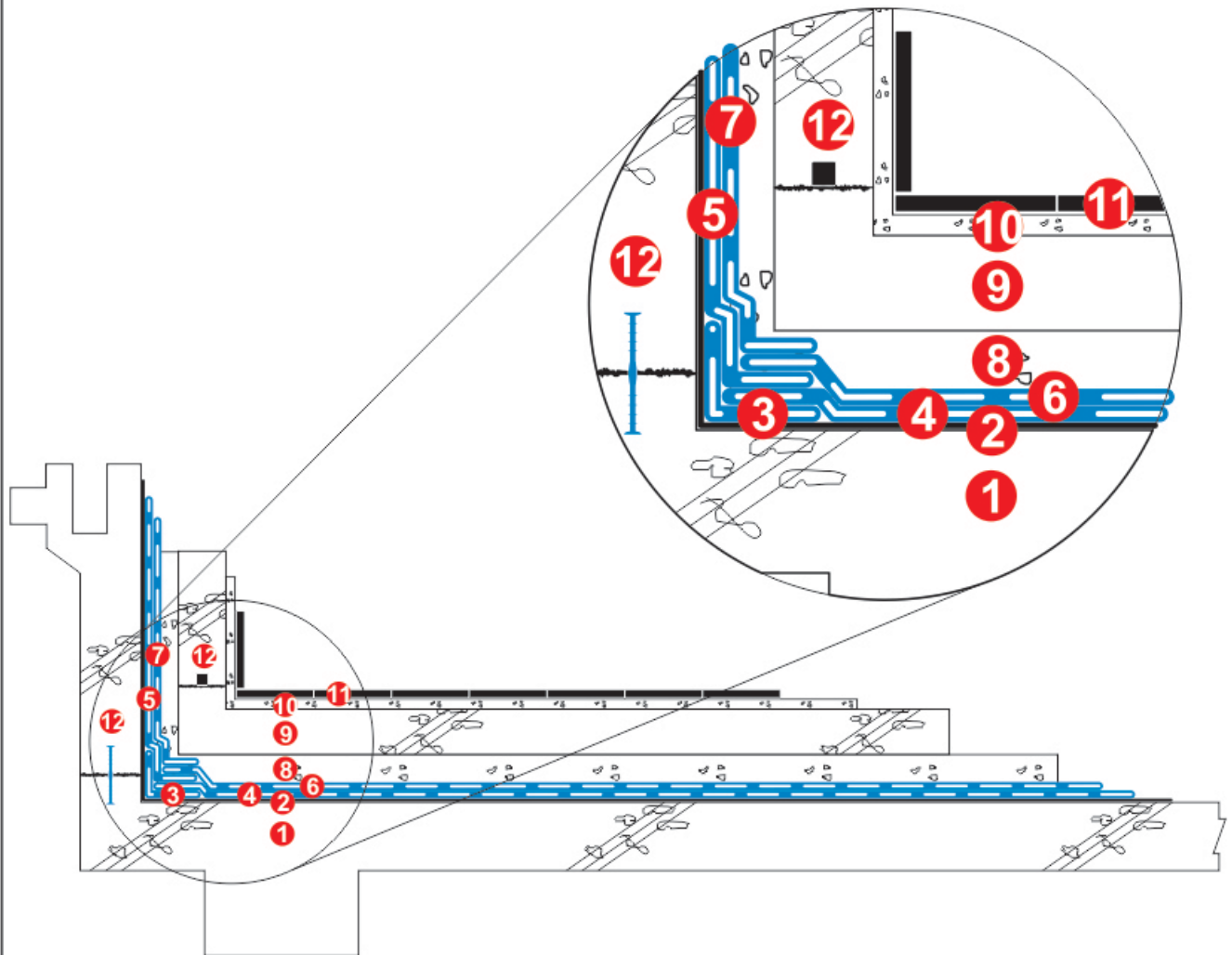

WATERPROOFING FOR / CHỐNG THẤM CHO SWIMMING POOL HỒ BƠI

Project:

Shop Drwg

WATERPROOFING TO FLOOR & WALL

1. R.C slab
2. Primer coats
3. Corner reinforcement: **SOPRALENE FLAM 180**
4. Waterproofing system: First layer **SOPRALENE FLAM 180**
5. Waterproofing upturn: First layer **SOPRALENE FLAM 180**
6. Waterproofing system: Second layer **SOPRALENE FLAM 180**
7. Waterproofing upturn: Second layer **SOPRALENE FLAM 180**
8. Protection screed for floor
9. R.C protection
10. Tile adhesive mortar
11. Tile finish
12. **PVC waterstop** or **Hyperstop** (Option).

Manufacture & Supplier by:



Design & installation by:

